

FLAT SEATING PLAN

(No Centre Aisle)

Auditorium Mode with Seats in Rows ~ Stalls 550 + Gallery 186 = 736 Seats

STAGE

AA				5	6	7	8	9	10	11	12	13	14	15	16	17	18	19	20	21	22	23	24	25	26		AA					
A				5	6	7	8	9	10	11	12	13	14	15	16	17	18	19	20	21	22	23	24	25	26		A					
B				4	5	6	7	8	9	10	11	12	13	14	15	16	17	18	19	20	21	22	23	24	25	26	27	B				
C				4	5	6	7	8	9	10	11	12	13	14	15	16	17	18	19	20	21	22	23	24	25	26	27	C				
D				4	5	6	7	8	9	10	11	12	13	14	15	16	17	18	19	20	21	22	23	24	25	26	27	D				
E			2	3	4	5	6	7	8	9	10	11	12	13	14	15	16	17	18	19	20	21	22	23	24	25	26	27	28	29	E	
F			2	3	4	5	6	7	8	9	10	11	12	13	14	15	16	17	18	19	20	21	22	23	24	25	26	27	28	29	F	
G		1	2	3	4	5	6	7	8	9	10	11	12	13	14	15	16	17	18	19	20	21	22	23	24	25	26	27	28	29	30	G
H		1	2	3	4	5	6	7	8	9	10	11	12	13	14	15	16	17	18	19	20	21	22	23	24	25	26	27	28	29	30	H
J		1	2	3	4	5	6	7	8	9	10	11	12	13	14	15	16	17	18	19	20	21	22	23	24	25	26	27	28	29	30	J
K		1	2	3	4	5	6	7	8	9	10	11	12	13	14	15	16	17	18	19	20	21	22	23	24	25	26	27	28	29	30	K
L		1	2	3	4	5	6	7	8	9	10	11	12	13	14	15	16	17	18	19	20	21	22	23	24	25	26	27	28	29	30	L
M		1	2	3	4	5	6	7	8	9	10	11	12	13	14	15	16	17	18	19	20	21	22	23	24	25	26	27	28	29	30	M
N		1	2	3	4	5	6	7	8	9	10	11	12	13	14	15	16	17	18	19	20	21	22	23	24	25	26	27	28	29	30	N
O		1	2	3	4	5	6	7	8	9	10	11	12	13	14	15	16	17	18	19	20	21	22	23	24	25	26	27	28	29	30	O
P				3	4	5	6	7	8	9	10	11	12	13	14	15	16	17	18	19	20	21	22	23	24	25	26	27	28		P	
Q				3	4	5	6	7	8	9	10	11	12	13	14	15	16	17	18	19	20	21	22	23	24	25	26	27	28		Q	
R				4	5	6	7	8	9	10	11	12	13	14	15	16	17	18	19	20	21	22	23	24	25	26	27			R		
S				5	6	7	8	9	10	11	12	13	14	15	16	17	18	19	20	21	22	23	24	25	26				S			
T				6	7	8	9	10	11	12	13	14	15	16	17	18	19	20	21	22	23	24	25						T			
U				6	7	8	9	10	11	12	13	14	15	16	17	18	19	20	21	22	23	24	25						U			

Stalls are located on Main Level of Auditorium and is in a Flat Level Format

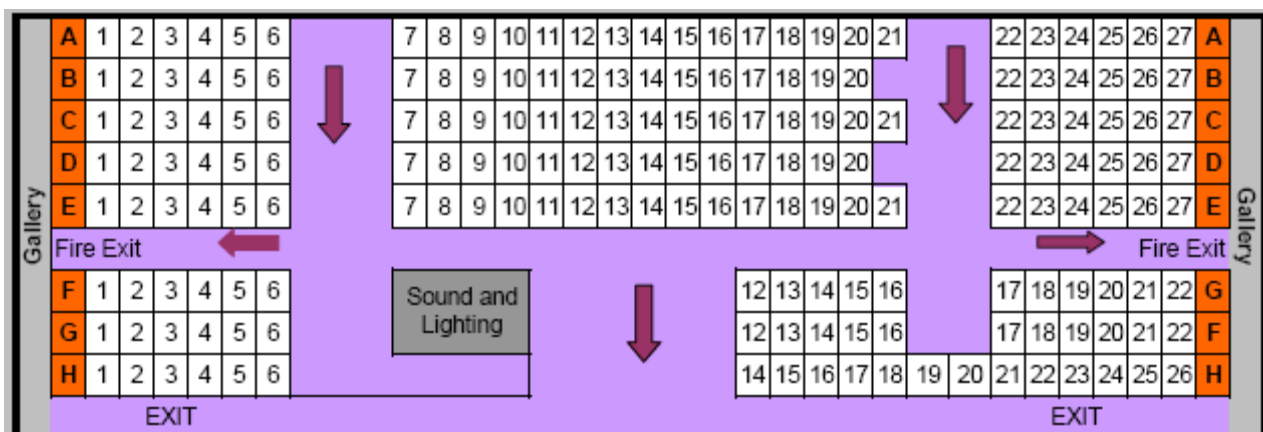

The Gallery is located upstairs of the Main Auditorium and is in a Grandstand Style Format (Tiered Seating looking down at the stage)